

# The Pellbow<sup>®</sup>

Bulkmatology<sup>®</sup> Solutions

- ✓ Wear resistant
- ✓ Eliminates streamers
- ✓ Reduces fines



## The Challenge

Create a solution that would reduce unwanted fines, eliminate the formation of streamers and be wear resistant; to perform above and beyond the typical long or short radius elbow.

## The Solution

Using a Pellbow<sup>®</sup> avoids problems caused by friction in traditional elbows.

### The Working Principle

The Pellbow<sup>®</sup> Resists Wear – Naturally. In traditional long radius elbow installations, the conveyed product slides along the elbow wall at a high velocity. The strong centrifugal force presses the product against the outer metal surface. This causes friction and heat which creates streamers and breakage. By design, material flowing through the Pellbow<sup>®</sup> accumulates in the pocket or “impact zone” and moves slowly upward and out. Incoming material is deflected at 90 degrees with minimum resistance and no impact damage.



### Pellbow<sup>®</sup> Installation on a Silo

The orientation of the Pellbow<sup>®</sup> can vary based on requirements. The space required is far less than required for a standard long radius elbow.

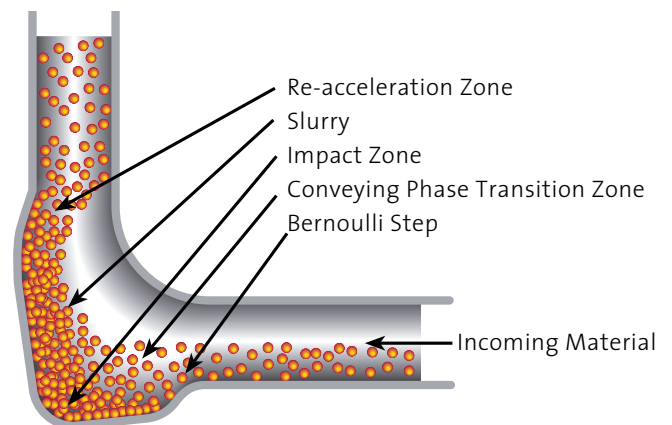
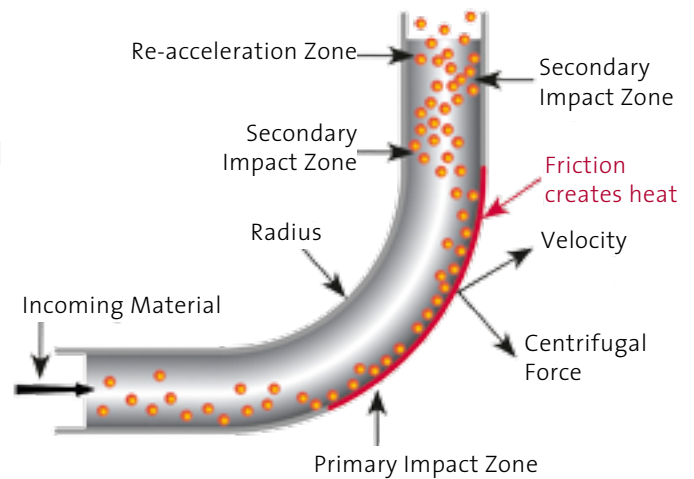

### Pellbow<sup>®</sup> Applications

- All high and low density dilute phase systems
- Plastic pellets, other granules and abrasive products
- Replacement of long and short radius elbows and other pipe bends

### Pellbow<sup>®</sup> Features

- Compact and easy to install
- 100% self-cleaning
- Reduced noise level
- Minimized pressure drop
- Various fittings and metals to address a wide range of requirements

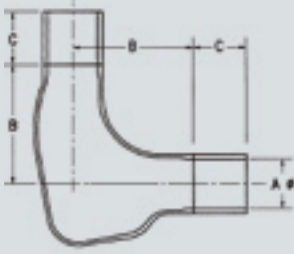

**Type 2: Stub End version**

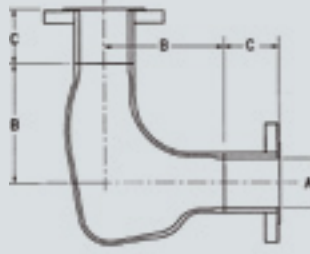

**Type 3: Loose or Welded Flange version**

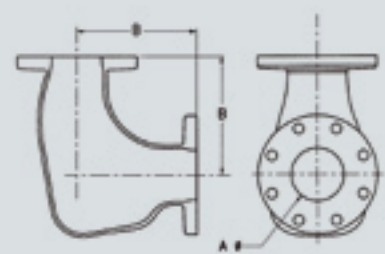

**Type 4: Cast Flange version**

**In General**

- All sizes are available in aluminum, stainless steel and cast iron
- Abrasive resistant alloy versions and coatings are available upon request
- Flanges are available in ANSI, DIN and JIS
- Stub end version for compression coupling connection is available for tube and pipe
- Loose flanges available in aluminium, stainless steel and cast iron
- Special designs and fittings are available upon request

## Measurements and Weights

(all measurements and weights are approximate)

Nominal Size Inches (mm)	Dimensions			SS lbs (kg)	Type 2 Iron lbs (kg)		SS lbs (kg)	Type 3 Iron lbs (kg)		Al lbs (kg)	Type 4 Iron lbs (kg)
	DIM A Inches (mm)	DIM B Inches (mm)	DIM C Inches (mm)		Al lbs (kg)	SS lbs (kg)		Al lbs (kg)			
1.5 (40)	1.3 (33)	6.0 (150)	4.0 (100)	5 (2.5)	5.5 (2.5)	2 (1)	*	*	*	*	
2.0 (50)	1.8 (46)	6.5 (170)	4.0 (100)	7 (3)	7.5 (3.5)	3 (1.5)	17 (8)	18 (8)	13 (6)	*	
2.5 (65)	2.3 (58)	7.0 (180)	4.0 (100)	9 (4)	9.5 (4.5)	3 (1.5)	25 (11)	25.5 (11)	18 (8)	*	
3.0 (75)	2.8 (70)	7.75 (200)	4.0 (100)	15 (7)	23 (11)	6 (3)	33 (15)	38 (17)	24 (11)	*	
4.0 (100)	3.8 (95)	9.0 (230)	4.0 (100)	28 (13)	31 (14)	11 (5)	54 (25)	52 (24)	36 (16)	23 (11)	
5.0 (125)	4.7 (120)	10.0 (260)	6.0 (150)	40 (18)	45 (21)	18 (8)	68 (31)	70 (32)	44 (20)	27 (12)	
6.0 (150)	5.8 (146)	11.5 (290)	6.0 (150)	60 (27)	80 (37)	33 (15)	83 (38)	90 (41)	51 (23)	*	
8.0 (200)	7.8 (198)	14.0 (360)	6.0 (150)	155 (70)	150 (68)	49 (22)	195 (89)	185 (84)	76 (35)	*	
10.0 (254)	9.5 (242)	16.5 (420)	6.0 (150)	200 (91)	205 (94)	70 (32)	274 (124)	275 (126)	130 (59)	*	
12.0 (300)	11.3 (286)	20.0 (500)	8.0 (200)	*	*	90 (41)	*	*	155 (70)	*	

\* Special order

**Part Number Nomenclature Example:**

**Nominal Size**

- Inches (mm)
- 015 - 1.5 (40)
- 020 - 2.0 (50)
- 025 - 2.5 (64)
- 030 - 3.0 (75)
- 040 - 4.0 (100)
- 050 - 5.0 (125)
- 060 - 6.0 (150)
- 080 - 8.0 (200)
- 100 - 10.0 (250)
- 120 - 12.0 (300)

**030-SS-T3-A-3.5"/3.068"**

**Pipe/Tube OD/ID**

OD – Outside Dimension  
ID – Inside Dimension

**Material Type**

- CI – Cast Iron
- SS – Stainless Steel
- AL – Aluminium
- AR – Abrasion Resistant
- Other alloys available

**Style**

- T2 – Stub End
- T3 – Loose or Welded Flange
- T4 – Cast Flange

**Flange Availability**

- A – ANSI
- D – DIN
- J – JIS
- N – No Flange
- S – Special

Pelletron Corporation  
1866 Colonial Village Lane  
Lancaster, PA 17601 · USA  
t +1.717.293.4008  
f +1.717.293.4011  
www.pelletroncorp.com  
info@pelletroncorp.com

pelletroneurope GmbH  
Ahornstraße 28  
88285 Bodnegg · Germany  
t +49(0)7520.95662-0  
f +49(0)7520.95662-15  
www.pelletroneurope.com  
info@pelletroneurope.com

**pelletron**  
Discover Bulkmatology®  
The Nature of Bulk Material Handling

